

TREE PROTECTION PLAN

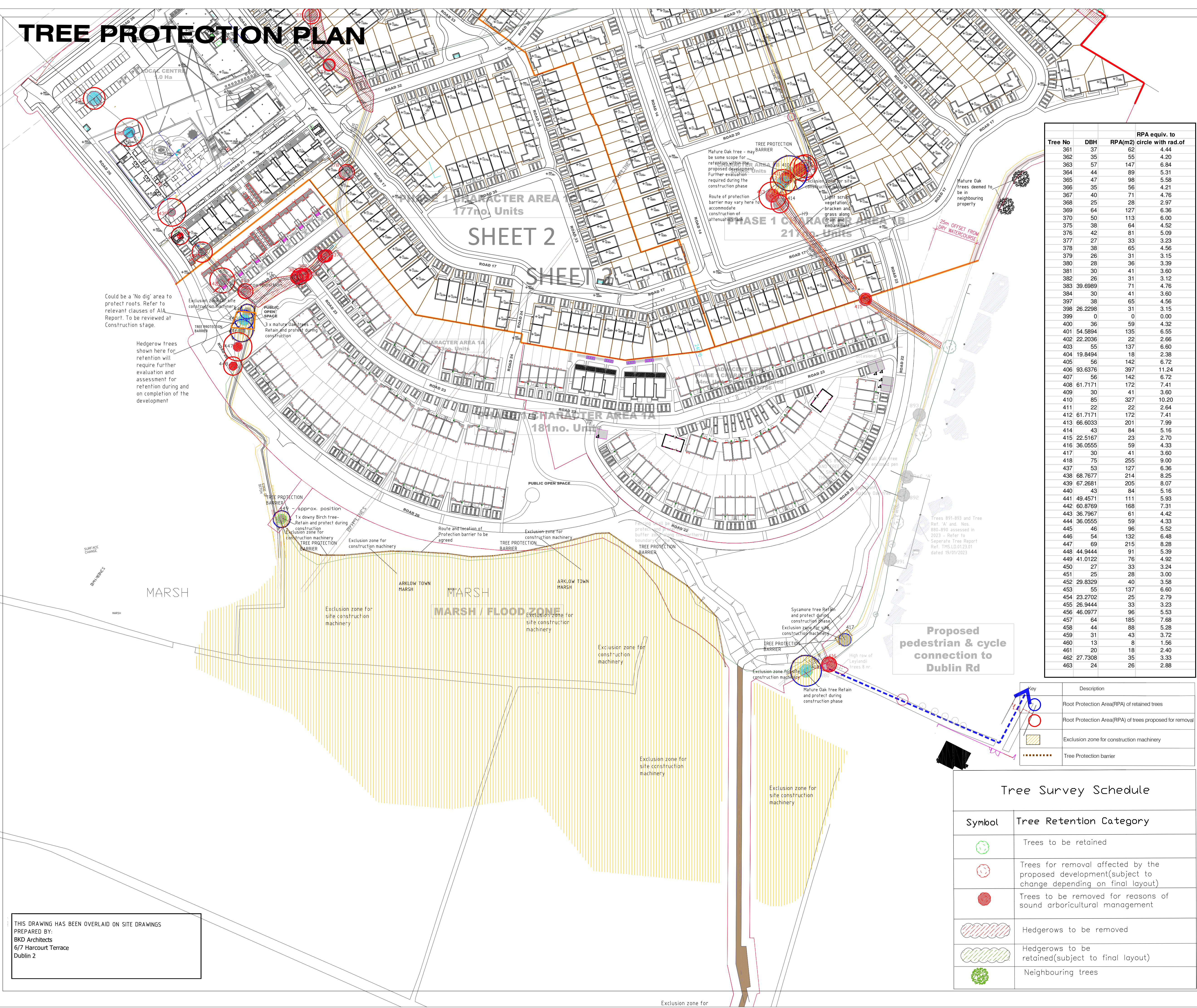

Tree No	DBH	RPA(m2)	RPA equiv. to circle with rad.of
361	37	62	4.44
362	35	55	4.20
363	57	147	6.84
364	44	89	5.31
365	47	98	5.58
366	35	56	4.21
367	40	71	4.76
368	25	28	2.97
369	64	127	6.96
370	50	113	6.00
375	38	64	4.52
376	42	81	5.09
377	27	33	3.23
378	38	65	4.56
379	26	31	3.15
380	28	36	3.39
381	30	41	3.60
382	26	31	3.12
383	39.6989	71	4.76
384	30	41	3.60
397	38	65	4.56
398	26.2298	31	3.15
399	0	0	0.00
400	36	59	4.32
401	54.5894	135	6.55
402	22.2036	22	2.66
403	55	137	6.80
404	19.8494	18	2.38
405	56	142	6.72
406	93.6376	397	11.24
407	56	142	6.72
408	61.7171	172	7.41
409	30	41	3.60
410	85	327	10.20
411	22	22	2.64
412	61.7171	172	7.41
413	66.6033	201	7.99
414	43	84	5.16
415	22.5167	23	2.70
416	36.0555	59	4.33
417	30	41	3.60
418	75	255	9.00
437	53	127	6.36
438	68.7677	214	8.25
439	67.2681	205	8.07
440	43	84	5.16
441	49.4571	111	5.93
442	60.8769	168	7.31
443	36.7967	61	4.42
444	36.0555	59	4.33
445	46	96	5.52
446	54	132	6.48
447	69	215	8.28
448	44.9444	91	5.39
449	41.0122	76	4.92
450	27	33	3.24
451	25	28	3.00
452	29.8329	40	3.58
453	55	137	6.60
454	23.2702	25	2.79
455	26.9444	33	3.23
456	46.0977	96	5.53
457	64	185	7.68
458	44	88	5.28
459	31	43	3.72
460	13	8	1.56
461	20	18	2.40
462	27.7308	35	3.33
463	24	26	2.88

Notes:
This drawing to be read in conjunction with all relevant Architects & Engineers drawings & specifications. For construction and site works refer to Civil Engineering drawings.
Do not scale from this drawing. Use figured dimensions only.

Refer to the Tree Survey Report carried out by Green Tree Arboricultural Consultants dated April 2025 who carried out the field assessments.

Trees shown for retention and removal are derived from the Arboricultural Impact Assessment(AIA) Report carried out by Green Tree Arboricultural Consultants dated April 2025. Trees shown for retention are subject to further evaluation and assessments during the construction phase. Any additional trees to be removed and shown as retained, will require Planning consent from the Local Authority. Retained trees will also be subject to on-site tree protection measures adopted during the construction phase, finished ground levels, location of services and other site developments. Retained trees shall be reassessed on completion of the construction phase and may require removal/remedial works following reassessment.

- Site Specific Tree Protection measures:
1. Refer to the the Arboricultural Impact Assessment(AIA) Report carried out by Green Tree Arboricultural Consultants dated April 2025.
 2. Erect Tree Protection barriers at the maximum setback distance possible from the tree at min. to RPA extent prior to the commencement of site works.
 3. Preserve and protect existing ground levels and soils and damage to root structures of retained trees and hedgerows shall be avoided within the protected RPA zones during the construction phase. Refer to the relevant clauses of BS 5837:2012.
 4. Topsoil shall not be deposited within these zones and excess topsoil shall be moved off site.
 5. Any excavation along the verges of RPA zones shall be hand dug only, taking care not to damage or disrupt existing root patterns.
 6. Where movements are to occur within the RPA, then the installation of ground protection measures shall be carried out. New temporary ground protection should be capable of supporting any traffic entering or using the site without being distorted or causing compaction of underlying soil.
 7. Avoid machinery damage to overhanging tree limbs. Assess and prune back and crown raise low limbs that overhang the site, prior to construction machinery entering the site.
 8. The area known as Arklow Town Marsh shall be protected during the construction phase. Refer to separate EIA report.
 - 9.Trees growing in the Arklow Marsh and abutting the proposed boardwalk shall be identified, assessed and protected during construction.
 10. Protection of all retained all be carried out in accordance with BS 5837:2012 Trees in relation to Design Demolition and Construction - Recommendations.



Tree Management Services

Arboriculture, Landscape and Forestry Consultants

21 Castleknock, Bollinacollig, Co. Cork

T: 021-4874365, M: 086 2532280

Email: phelanlj1@gmail.com

PROJECT
Mixed Use Large-Scale Residential Development at 'LANDS AT KILBRIDE' ARKLOW CO. WICKLOW

CLIENT
Certain Assets of Dawnhill and Windhill Limited

PRG. Ref: TMS.LD.04.25.02B Status:Planning SCALE: 1:1000 APPROX @ A1
Date:15-05-25 Sheet: 2 of 3

TREE PROTECTION PLAN

Tree Survey Schedule	
Symbol	Tree Retention Category
	Trees to be retained
	Trees for removal affected by the proposed development(subject to change depending on final layout)
	Trees to be removed for reasons of sound arboricultural management
	Hedgerows to be removed
	Hedgerows to be retained(subject to final layout)
	Neighbouring trees

THIS DRAWING HAS BEEN OVERLAID ON SITE DRAWINGS
PREPARED BY:
BKD Architects
6/7 Harcourt Terrace
Dublin 2