

STD-WW-03

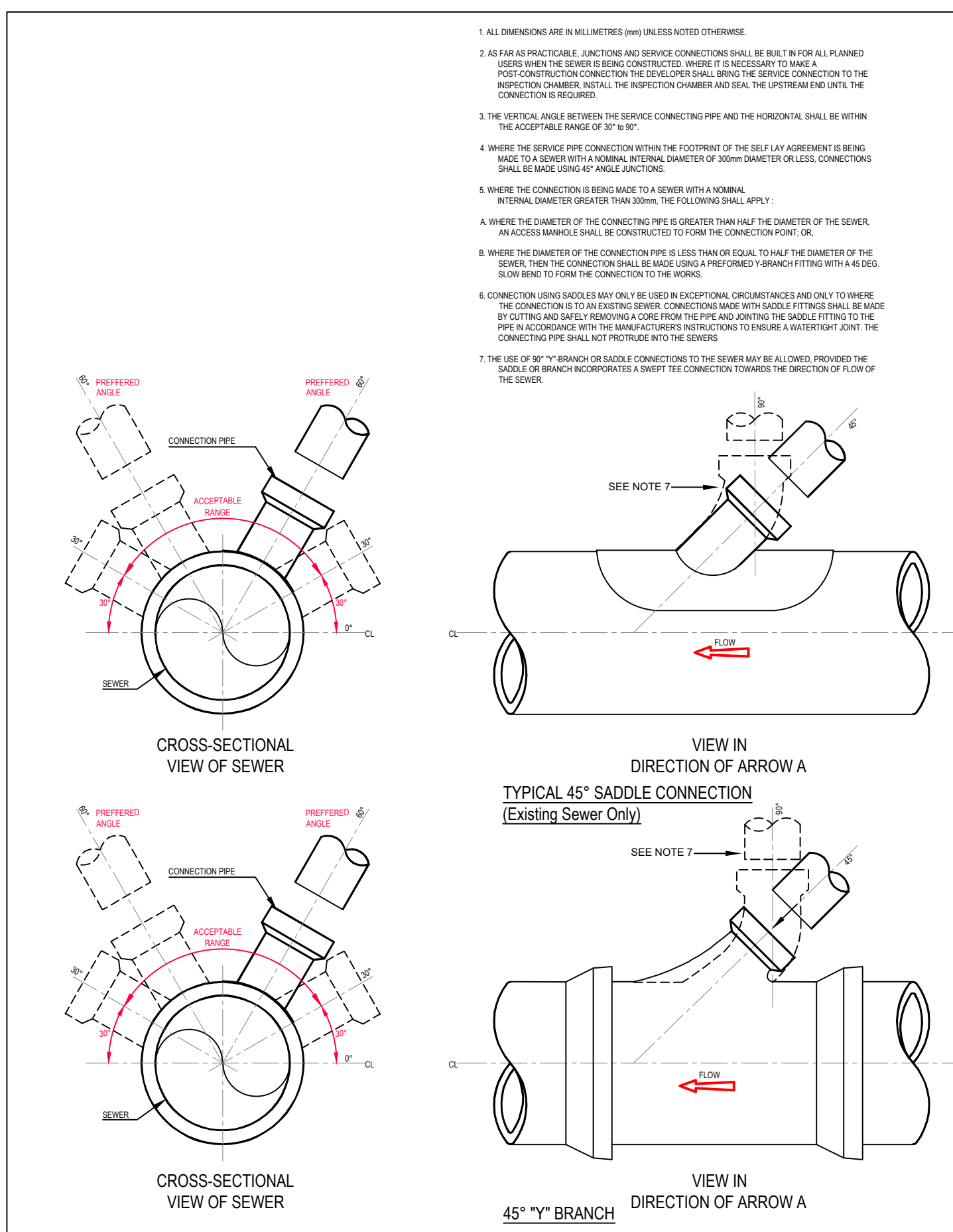

STD-WW-04

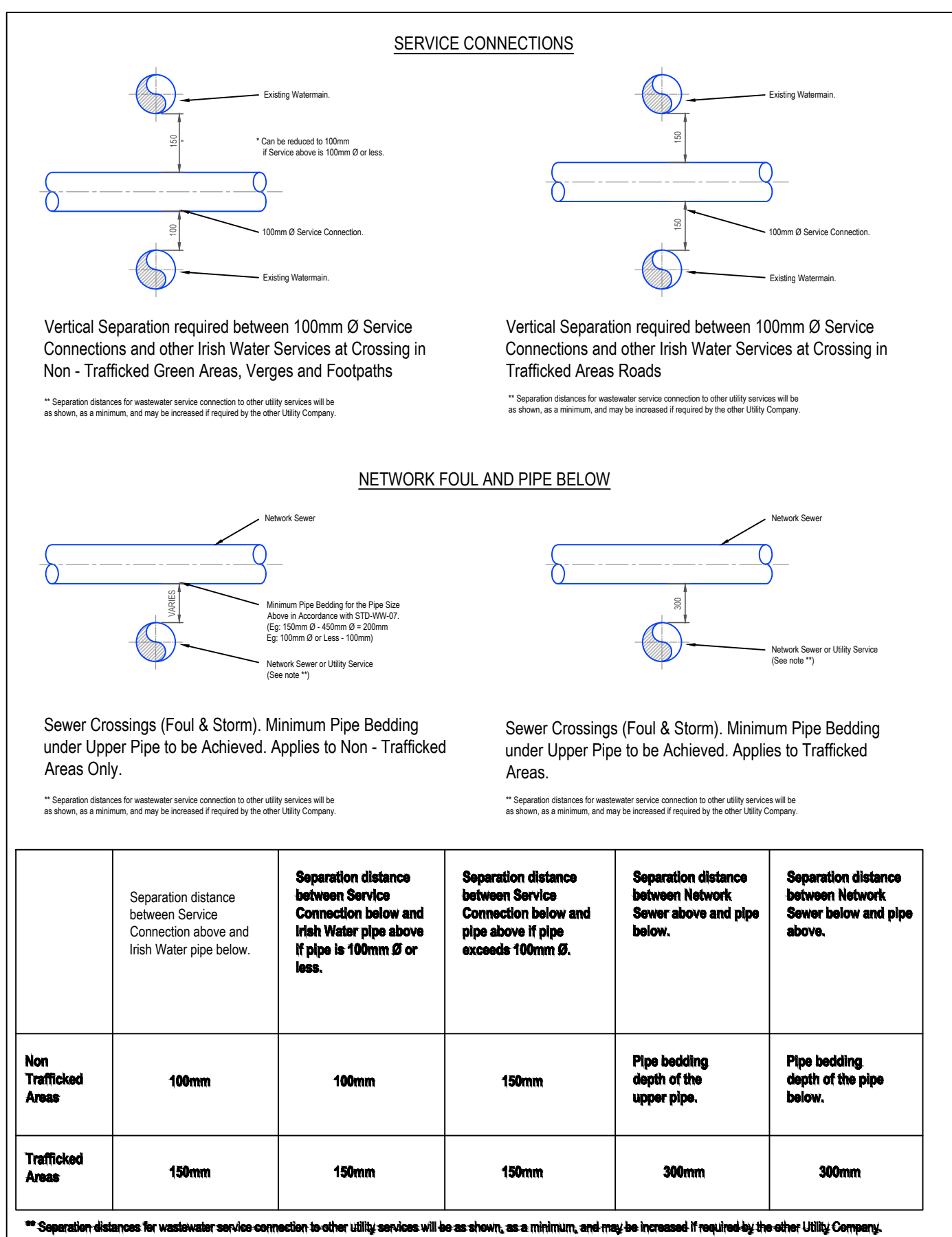

STD-WW-5A

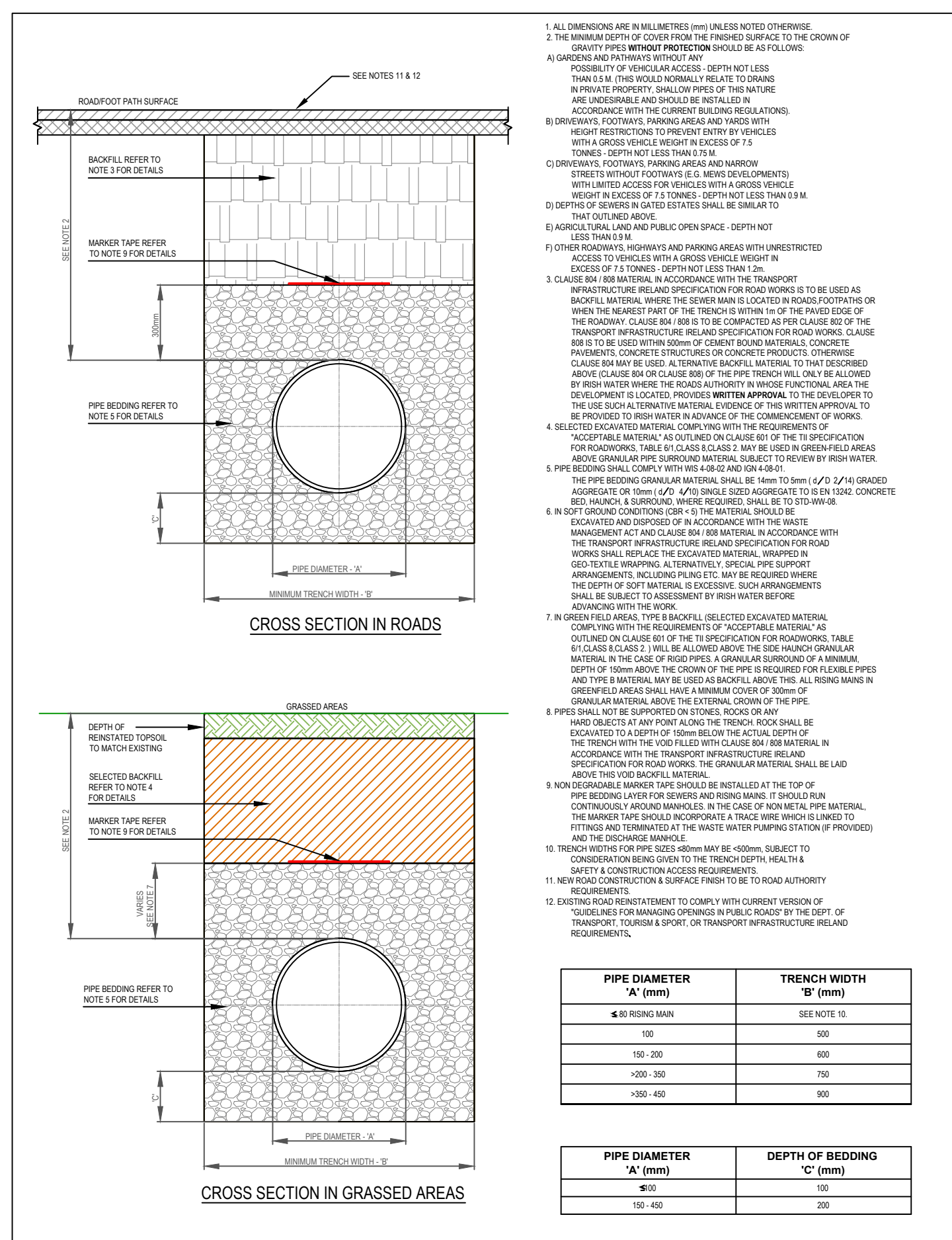

STD-WW-07

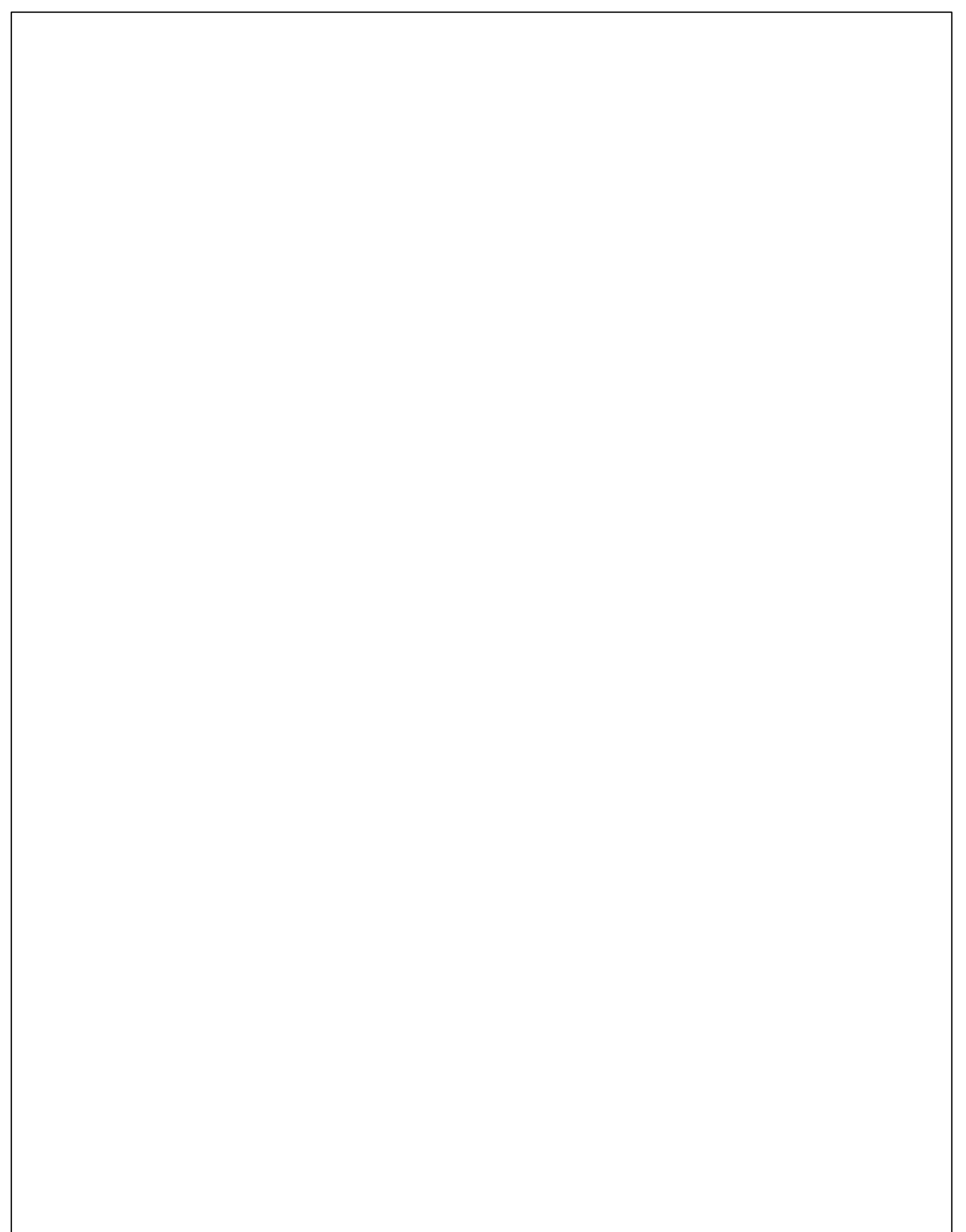

STD-WW-08

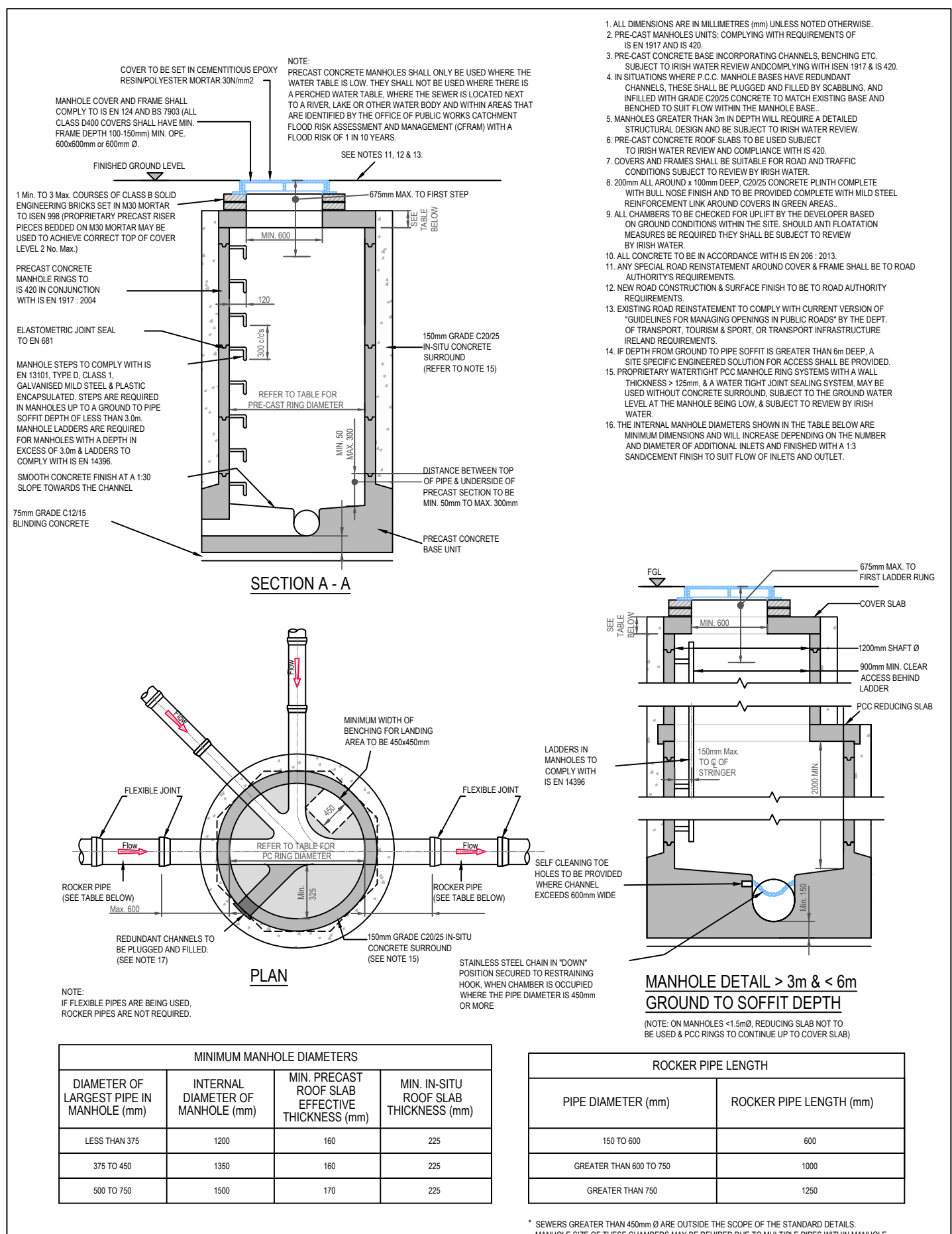

STD-WW-10A

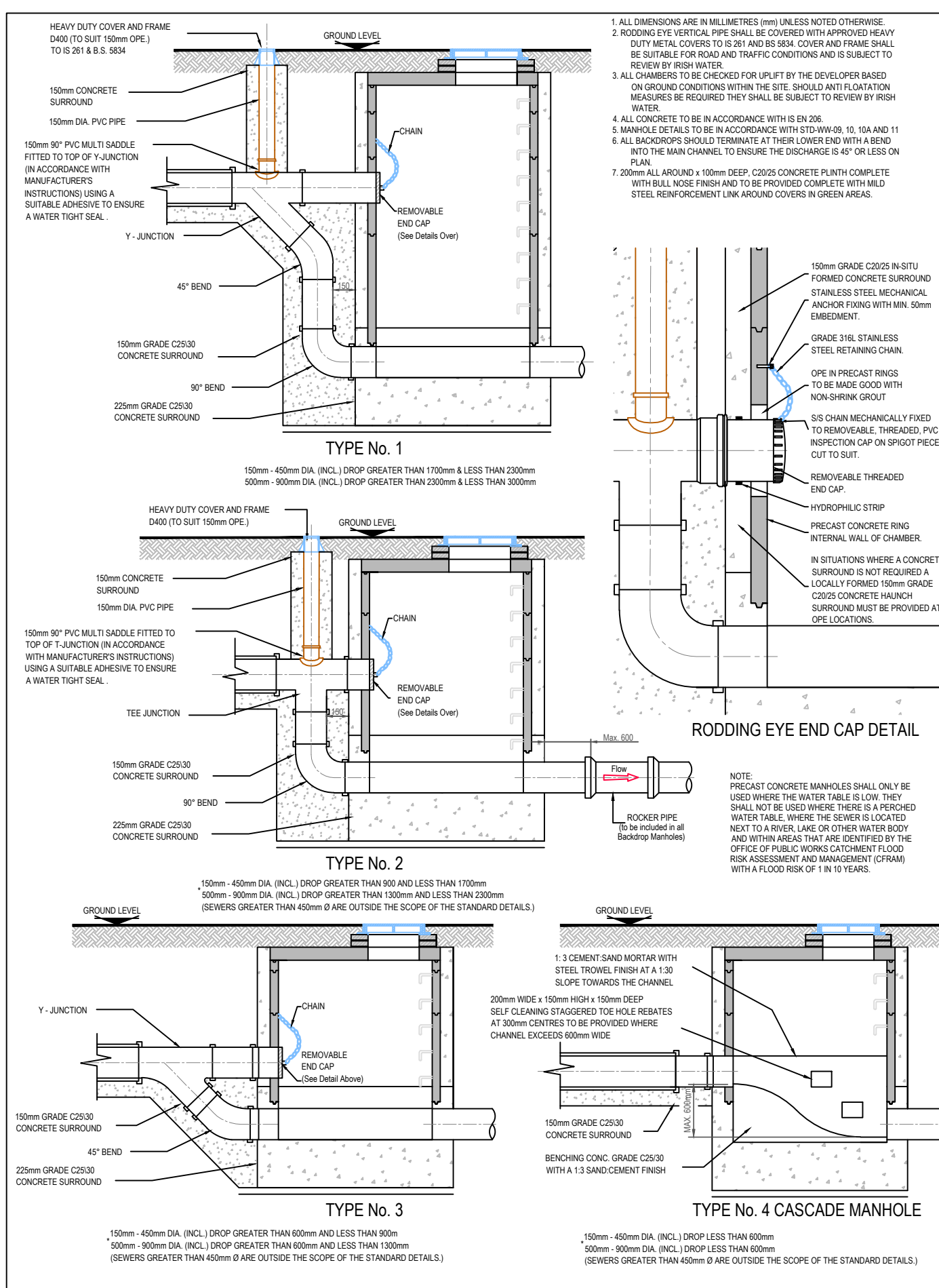

STD-WW-12

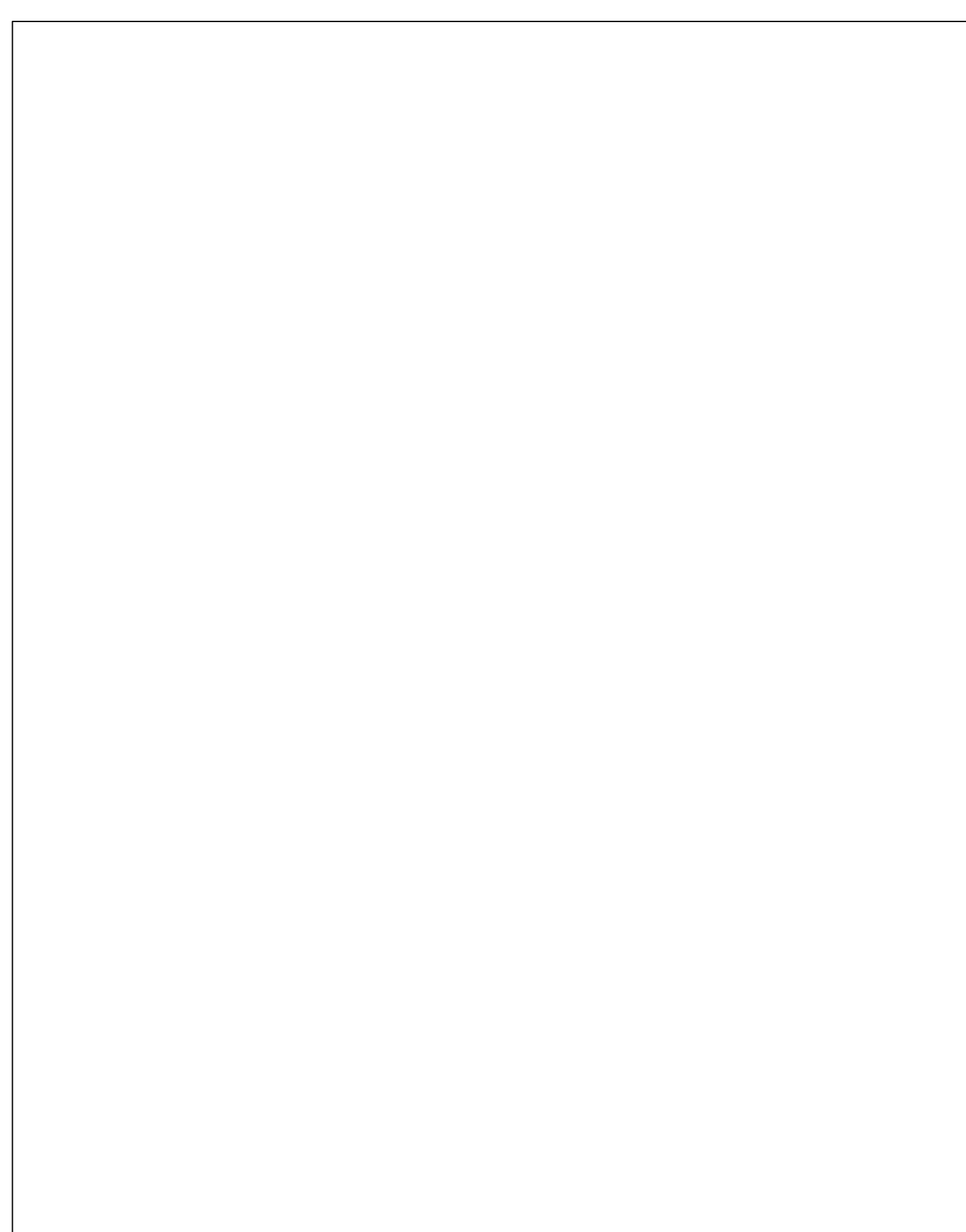

STD-WW-13

PLANNING ISSUE

S2.P05	ISSUED FOR PLANNING	19.05.2025	KD	MJC
S2.P04	ISSUED FOR INFORMATION	16.04.2025	KD	MJC
S2.P03	ISSUED FOR INFORMATION	31.03.2025	KD	MJC
S2.P02	ISSUED FOR S32B	25.10.2024	KD	MJC
S2.P01	DRAFT ISSUE	18.10.2024	NQ	MJC
Rev.	Note	Date	Drawn	Check

DONNACHADH O'BRIEN & ASSOCIATES CONSULTING ENGINEERS	UNIT 5C ELM HOUSE MILLENNIUM PARK NAAS CO. KILDARE	P +353 45 984 042 INFO@DOB.AE WWW.DOB.AE
	DONNACHADH O'BRIEN & ASSOCIATES CONSULTING ENGINEERS 100 MILLLENNIUM PARK, NAAS, CO. KILDARE, IRELAND	

Client: CERTAIN ASSETS OF DAWN HILL AND WINDHILL LIMITED

Project: LANDS AT KILBRIDE, ARKLOW, Co. WICKLOW

Drawing Title: PROPOSED WASTEWATER DETAILS

Drawn By: NQ	Checked By: MC	Approved By: DOB	Date: OCT 2024	Scale: N.T.S.	Sheet Size: A0
-----------------	-------------------	---------------------	-------------------	------------------	-------------------

Project Number:	DORA2432	Drawing Number:	2432 DOR XY SL DB C 0370	Status Code:	S2	Rev Number:	D05
-----------------	----------	-----------------	--------------------------	--------------	----	-------------	-----

DODR2402	2402 DOD XA OF DR O 0010	02	100
----------	--------------------------	----	-----