

NOTES:

- FOR STANDARD DOBA NOTES REFER TO DRAWING 2432-DOB-XX-SI-DR-S-001 & S-002
- REFER TO ARCHITECT'S DRAWINGS FOR ALL SITE & APPLICATION BOUNDARIES
- THIS DRAWING IS TO BE READ IN CONJUNCTION WITH ALL OTHER RELEVANT ARCHITECT'S & ENGINEER'S DRAWINGS AND SPECIFICATIONS.
- USE FIGURED DIMENSIONS ONLY. DO NOT SCALE.
- REFER TO SURVEY DRAWINGS FOR EXISTING SERVICES LAYOUTS AND MANHOLE INFORMATION
- ALL EXISTING SURFACES TO BE REINSTATED FOLLOWING OVERSATION OF SERVICES/CONSTRUCTION OF NEW SERVICES
- THE CONTRACTOR SHALL VERIFY ALL DIMENSIONS AND LEVELS WITH ARCHITECTURAL DRAWINGS PRIOR TO START OF CONSTRUCTION. ANY DISCREPANCIES TO BE NOTIFIED TO THE ENGINEER & ARCHITECT FOR RESOLUTION
- CONTRACTOR TO ENSURE ALL WATER & WASTEWATER RELATED WORKS ARE IN ACCORDANCE WITH THE IRISH WATER WATER INFRASTRUCTURE & WASTEWATER INFRASTRUCTURE CODE OF PRACTICE & STANDARD DETAILS DOCUMENTS
- TESTING OF ALL GRAVITY SEWERS AND MANHOLES TO BE IN ACCORDANCE WITH IRISH WATER CODE OF PRACTICE FOR WASTEWATER INFRASTRUCTURE SECTION 4.10 TESTING OF GRAVITY SEWERS & MANHOLES

SURFACE WATER LEGEND:

- EX. SURFACE WATER SEWER
- EX. SURFACE WATER MANHOLE
- EX. SURFACE WATER INSPECTION CHAMBER
- EX. SURFACE WATER ACCESS JUNCTION
- EX. WATER COURSE
- EX. COMBINED SEWER
- EX. COMBINED MANHOLE
- EX. SURFACE WATER SEWER TO BE DECOMMISSIONED
- PR. SURFACE WATER SEWER
- PR. SURFACE WATER MANHOLE
- PR. SURFACE WATER INSPECTION CHAMBER
- PR. SURFACE WATER ACCESS JUNCTION
- PR. RAINWATER HARVESTING SEWER
- PR. RAINWATER HARVESTING MANHOLE
- PR. RAINWATER HARVESTING INSPECTION CHAMBER
- PR. RAINWATER HARVESTING ACCESS JUNCTION
- PR. ROAD GULLY
- PR. ATTENUATION TANK
- PR. PERMEABLE PAVING (CAR PARKING)
- PR. PERMEABLE PAVING
- PR. FILTER DRAIN
- PR. DRAINAGE CHANNEL
- PR. BIORETENTION AREA
- PROPOSED RETENTION POND
- PR. PETROL INTERCEPTOR
- PR. RAINWATER HARVESTING TANK
- PR. KERB DRAIN
- PR. DROPPED KERB
- PR. TREE PIT DISCHARGING TO MAIN SW DRAINAGE

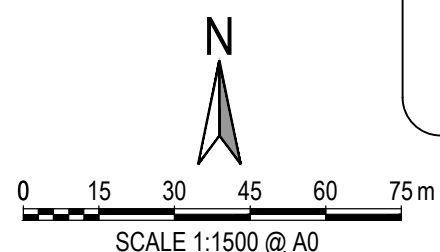

- NOTE 1: MANHOLE COVER LEVELS ARE APPROXIMATE. ACTUAL COVER LEVELS SHOULD MATCH SURROUNDING FINISHED GROUND LEVELS U.N.O.
- NOTE 2: PIPES WITH LESS COVER THAN
- 600mm FOR GRASSED AREAS
 - 900mm FOR FOOTPATHS
 - 1200mm FOR ROADS
- TO BE SURROUNDED IN 150mm CONCRETE PROTECTION IN ACCORDANCE WITH IRISH WATER STANDARD DETAIL STD-WW-07
- NOTE 3: ALL MANHOLE COVERS LOCATED IN GRASS AREAS TO BE SURROUNDED (Min. 200mm SURROUND) IN 100mm THK C20/25 CONCRETE APRON

SURFACE WATER MATERIAL TO BE IN ACCORDANCE WITH THE CODE OF PRACTICE FOR DRAINAGE WORKS

- UNPLASTICISED P.V.C. PIPES MUST COMPLY WITH THE 'PROVISIONAL UNPLASTICISED P.V.C.' ISSUED BY THE DEPARTMENT OF THE ENVIRONMENT.
- B.S. 8005: PART 1 - SEWERAGE OR EQUIVALENT.
- B.S. 8018: PART 2 - PIPELINES ON LAND OR EQUIVALENT. DESIGN, CONSTRUCTION & INSTALLATION.
- B.S. 5965: PART 6 CODE OF PRACTICE FOR THE INSTALLATION OF UNPLASTICISED P.V.C. PIPEWORK FOR GRAVITY DRAINS & SEWERS OR EQUIVALENT
- EN1401 - UNPLASTICISED P.V.C. SEWER PIPE SPECIFICATION
- B.S.4514 - UNPLASTICISED P.V.C. SOIL PIPE SPECIFICATION
- DOE/H.G SITE DEVELOPMENT WORKS' SECTION H OF THE BUILDING REGULATIONS

PLANNING ISSUE

S2.P04	ISSUED FOR PLANNING	19.05.2025	KD	MJC
S2.P03	ISSUED FOR INFORMATION	16.04.2025	KD	MJC
S2.P02	ISSUED FOR S32B	25.10.2024	KD	MJC
S2.P01	DRAFT ISSUE	18.10.2024	NQ	MJC
Rev.	Note	Date	Drawn	Check

DONNACHADH O'BRIEN & ASSOCIATES CONSULTING ENGINEERS	UNIT 3C ELM HOUSE MILLERSHAW PARK NAAS CO. KILDARE	P-353 45 984 042 INFO@DOBA.E WWW.DOB.AE
----------------------------------------------------------------	----------------------------------------------------------------	-----------------------------------------------

Client:	CERTAIN ASSETS OF DAWN HILL AND WINDHILL LIMITED			
Project:	LANDS AT KILBRIDE, ARKLOW, Co. WICKLOW			
Drawing Title:	PROPOSED SURFACE WATER DRAINAGE LAYOUT OVERALL			
Drawn By:	Checked By:	Approved By:	Date:	Scale:
KD	PD	DOB	OCT 24	1:1500
Project Number:	Drawing Number:	Status Code:	Rev Number:	
DOBA2432	2432-DOB-XX-SI-DR-C-0200	S2	P04	

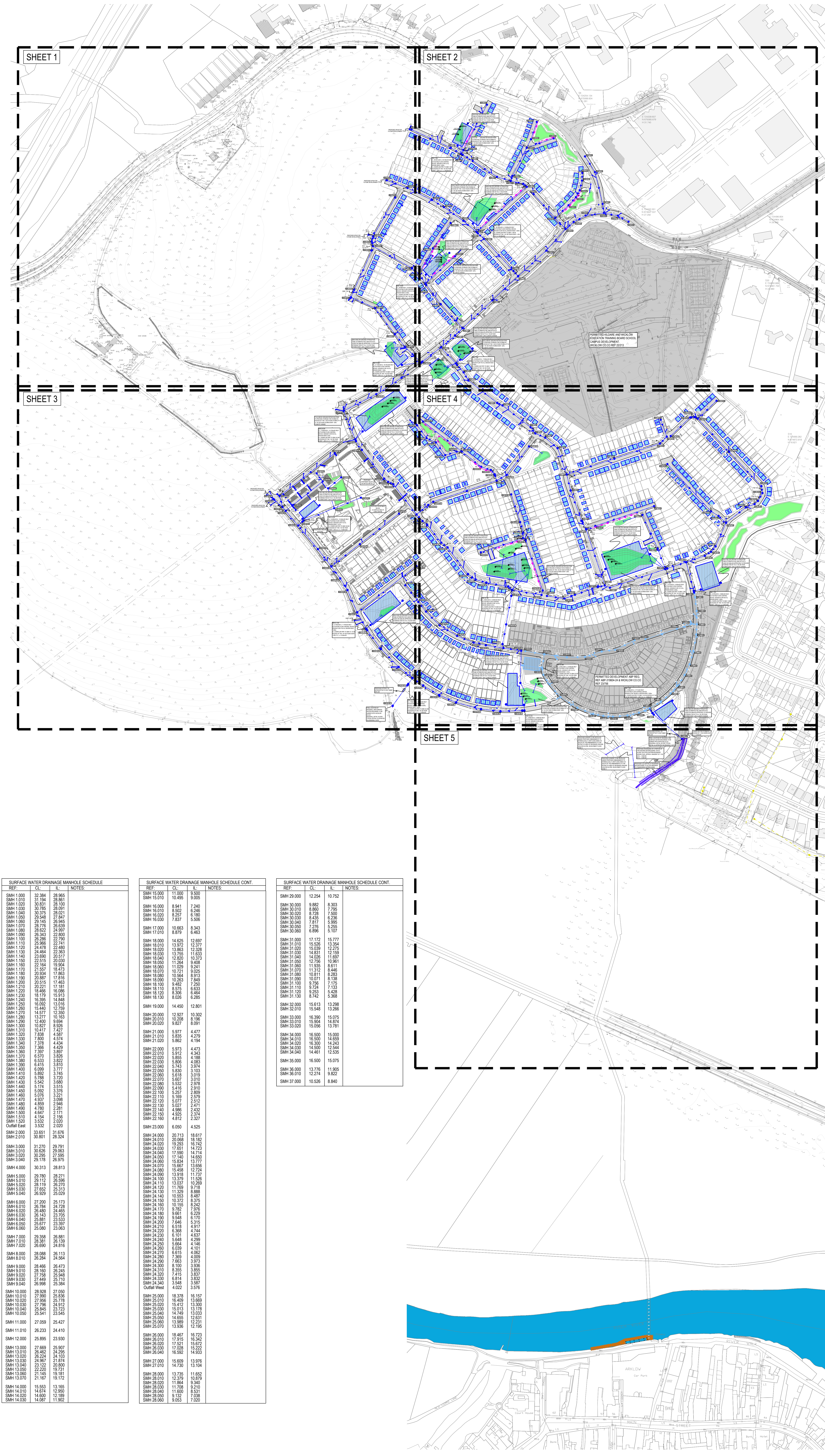

REF.	CL.	IL.	NOTES:
SMH 1.000	32.384	28.865	
SMH 1.010	31.194	28.861	
SMH 1.020	30.831	28.100	
SMH 1.030	30.785	28.091	
SMH 1.040	30.375	28.021	
SMH 1.050	25.446	27.847	
SMH 1.060	25.145	26.945	
SMH 1.070	25.775	26.939	
SMH 1.080	26.622	24.997	
SMH 1.100	25.343	22.930	
SMH 1.110	25.965	22.790	
SMH 1.120	24.475	22.440	
SMH 1.130	24.464	22.353	
SMH 1.140	23.690	20.517	
SMH 1.150	22.515	20.030	
SMH 1.160	22.164	19.904	
SMH 1.170	21.557	18.473	
SMH 1.180	20.934	17.863	
SMH 1.190	20.857	17.816	
SMH 1.200	20.515	17.453	
SMH 1.210	20.221	17.181	
SMH 1.220	18.466	16.086	
SMH 1.230	18.179	15.913	
SMH 1.240	16.385	14.868	
SMH 1.250	16.092	13.016	
SMH 1.260	15.460	12.739	
SMH 1.270	14.577	12.300	
SMH 1.280	13.277	10.153	
SMH 1.290	12.400	8.994	
SMH 1.300	10.927	6.926	
SMH 1.310	10.417	7.427	
SMH 1.320	7.938	4.957	
SMH 1.330	7.800	4.574	
SMH 1.340	7.378	4.434	
SMH 1.350	7.366	4.429	
SMH 1.360	7.297	4.367	
SMH 1.370	6.570	3.826	
SMH 1.380	6.533	3.822	
SMH 1.390	6.415	3.810	
SMH 1.400	6.099	3.777	
SMH 1.410	5.892	3.745	
SMH 1.420	5.788	3.720	
SMH 1.430	5.642	3.680	
SMH 1.440	5.174	3.515	
SMH 1.450	5.062	3.376	
SMH 1.460	5.076	3.221	
SMH 1.470	4.837	3.098	
SMH 1.480	4.859	2.946	
SMH 1.490	4.780	2.921	
SMH 1.500	4.647	2.771	
SMH 1.510	4.154	2.186	
SMH 1.520	3.532	2.020	
SMH 1.530	3.530	2.020	
SMH 2.000	33.651	31.676	
SMH 2.010	30.891	28.324	
SMH 3.000	31.270	29.791	
SMH 3.010	30.626	29.093	
SMH 3.020	30.295	27.595	
SMH 3.040	25.175	26.975	
SMH 4.000	30.313	28.813	
SMH 5.000	28.780	28.771	
SMH 5.010	28.112	26.596	
SMH 5.020	26.119	25.270	
SMH 5.030	27.692	25.313	
SMH 5.040	26.929	23.029	
SMH 6.000	27.200	25.173	
SMH 6.010	26.794	24.728	
SMH 6.020	26.480	24.465	
SMH 6.030	26.143	23.705	
SMH 6.040	25.891	23.323	
SMH 6.050	25.877	23.307	
SMH 6.060	25.080	23.063	
SMH 7.000	28.358	26.881	
SMH 7.010	26.381	26.139	
SMH 7.020	26.690	24.816	
SMH 8.000	28.088	26.113	
SMH 8.010	26.284	24.604	
SMH 9.000	28.466	26.473	
SMH 9.010	28.160	26.245	
SMH 9.020	27.758	25.846	
SMH 9.030	27.449	25.710	
SMH 9.040	25.980	25.394	
SMH 10.000	28.928	27.050	
SMH 10.010	27.990	26.636	
SMH 10.020	27.956	25.718	
SMH 10.030	27.796	24.912	
SMH 10.040	25.945	23.723	
SMH 10.050	25.541	23.545	
SMH 11.000	27.059	25.427	
SMH 11.010	26.233	24.410	
SMH 12.000	25.895	23.930	
SMH 13.000	27.669	25.907	
SMH 13.010	26.403	24.286	
SMH 13.020	26.224	24.103	
SMH 13.030	24.962	21.074	
SMH 13.040	23.122	20.800	
SMH 13.050	22.220	19.730	
SMH 13.060	21.145	19.181	
SMH 13.070	21.167	19.172	
SMH 14.000	13.553	13.165	
SMH 14.010	14.674	12.969	
SMH 14.020	14.690	12.189	
SMH 14.030	14.687	11.992	

REF.	CL.	IL.	NOTES:
SMH 15.000	11.000	9.150	
SMH 16.010	10.495	9.005	
SMH 16.000	8.941	7.240	
SMH 16.010	8.502	6.346	
SMH 16.020	8.257	6.180	
SMH 16.030	7.837	5.506	
SMH 17.000	10.363	8.343	
SMH 17.010	8.979	6.463	
SMH 18.000	14.625	12.697	
SMH 18.010	13.972	12.377	
SMH 18.020	13.963	12.326	
SMH 18.030	13.755	11.633	
SMH 18.040	12.300	10.373	
SMH 18.050	11.264	9.408	
SMH 18.060	11.029	8.913	
SMH 18.070	10.721	8.025	
SMH 18.080	10.564	8.913	
SMH 18.090	10.263	7.849	
SMH 18.100	9.462	7.501	
SMH 18.110	8.575	6.633	
SMH 18.120	8.306	6.464	
SMH 18.130	8.026	6.285	
SMH 19.000	14.450	12.801	
SMH 20.000	12.307	10.302	
SMH 20.010	10.206	8.196	
SMH 20.020	9.927	8.091	
SMH 21.000	5.977	4.477	
SMH 21.010	5.836	4.279	
SMH 21.020	5.862	4.194	
SMH 22.000	5.973	4.473	
SMH 22.010	5.912	4.343	
SMH 22.020	5.829	4.188	
SMH 22.030	5.906	4.083	
SMH 22.040	5.743	3.874	
SMH 22.050	5.830	3.103	
SMH 22.060	5.818	3.019	
SMH 22.070	5.607	3.010	
SMH 22.080	5.532	2.978	
SMH 22.090	5.416	2.810	
SMH 22.100	5.257	2.808	
SMH 22.110	5.169	2.579	
SMH 22.120	5.077	2.512	
SMH 22.130	5.027	2.471	
SMH 22.140	4.986	2.432	
SMH 22.150	4.925	2.374	
SMH 22.160	4.812	2.307	
SMH 23.000	6.050	4.525	
SMH 24.000	20.713	18.617	
SMH 24.010	20.068	18.182	
SMH 24.020	19.293	16.742	
SMH 24.030	17.651	14.723	
SMH 24.040	17.590	14.714	
SMH 24.050	17.140	14.650	
SMH 24.060	15.834	13.777	
SMH 24.070	15.967	13.656	
SMH 24.080	15.458	12.724	
SMH 24.090	13.918	11.737	
SMH 24.100	13.379	11.526	
SMH 24.110	13.037	10.829	
SMH 24.120	11.769	9.718	
SMH 24.130	11.329	8.888	
SMH 24.140	10.553	8.487	
SMH 24.150	10.372	8.175	
SMH 24.160	10.155	8.242	
SMH 24.170	9.762	7.076	
SMH 24.180	9.681	6.229	
SMH 24.190	9.548	6.170	
SMH 24.200	7.646	5.315	
SMH 24.210	6.918	4.915	
SMH 24.220	6.368	4.744	
SMH 24.230	6.101	4.637	
SMH 24.240	5.648	4.299	
SMH 24.250	5.664	4.146	
SMH 24.260	6.039	4.101	
SMH 24.270	5.915	4.062	
SMH 24.280	5.869	4.029	
SMH 24.290	7.663	3.973	
SMH 24.300	8.100	3.936	
SMH 24.310	8.355	3.855	
SMH 24.320	7.415	3.837	
SMH 24.330	6.814	3.832	
SMH 24.340	3.548	3.587	
Outfall West	4.022	3.576	
SMH 25.000	18.378	16.157	
SMH 25.010	16.409	13.669	
SMH 25.020	15.412	13.300	
SMH 25.030	15.003	13.178	
SMH 25.040	14.749	13.033	
SMH 25.050	14.655	12.631	
SMH 25.060	13.389	12.231	
SMH 25.070	13.536	12.195	
SMH 26.000	18.467	16.723	
SMH 26.010	17.915	16.342	
SMH 26.020	17.339	15.672	
SMH 26.030	17.028	15.222	
SMH 26.040	16.592	14.933	
SMH 27.000	13.609	13.676	
SMH 27.010	14.730	15.104	
SMH 28.000	13.735	11.652	
SMH 28.010	12.379	10.879	
SMH 28.020	11.864	9.340	
SMH 28.030	11.708	9.210	
SMH 28.040	11.600	8.531	
SMH 28.050	9.132	7.038	
SMH 28.060	9.053	7.000	

SURFACE WATER DRAINAGE MAN-HOLE SCHEDULE CONT.			
REF.	CL.	IL.	NOTES:
SMH 29.000	8.54	10.752	
SMH 30.000	9.882	8.303	
SMH 30.010	8.860	8.880	
SMH 30.020	8.728	8.500	
SMH 30.030	8.435	6.256	
SMH 30.040	7.817	5.995	
SMH 30.050	7.270	5.255	
SMH 30.060	6.896	5.107	
SMH 31.000	17.172	15.777	
SMH 31.010	15.206	13.354	
SMH 31.020	15.039	12.275	
SMH 31.030	14.831	12.149	
SMH 31.040	14.026	11.697	
SMH 31.050	11.756	10.361	
SMH 31.060	11.635	8.911	
SMH 31.070	11.312	8.446	
SMH 31.080	10.990	8.283	
SMH 31.090	10.717	8.138	
SMH 32.000	15.513	13.298	
SMH 32.010	15.648	13.266	
SMH 32.020	15.650	13.075	
SMH 33.000	15.904	14.871	
SMH 33.020	15.056	13.784	
SMH 34.000	16.500	15.000	
SMH 34.010	16.500	14.659	
SMH 34.020	16.500	14.269	
SMH 34.030	14.500	12.544	
SMH 34.040	14.461	12.535	
SMH 35.000	15.461	15.075	
SMH 36.000	13.776	11.406	
SMH 36.010	12.274	9.622	
SMH 37.000	10.526	8.840	